

2. Work to figured dimensions only. Do not scale drawing.
 3. The contractor is responsible for checking all levels and dimensions on site and shall refer all discrepancies to the Architect.
 4. Where appropriate, for further details contact Estates Department.
 5. Proprietary items shall be fixed in strict accordance with manufacturers instructions.
 6. Sizes of proprietary items shall be checked with manufacturer.
 7. The contractor shall be responsible for the coordination of structures, finishes and services.

ISSUE STATUS	No.	Date	Revision	Initials
TENDER				
CONSTRUCTION				
AS BUILT				

Project	TUS MIDLANDS MCCARRICK BUILDING - EAST CAMPUS - INFORMATION LAYOUT		
Drawing Title	MCCARRICK BUILDING LAYOUT	Scale	NTS
Drawing No.	MC-EC-2201	Rev	REV
Drawn	J.J.	Date	NOV 2022
Technological University of the Shannon - Midlands Midwest, Athlone, Co. Westmeath, Ireland TEL: (353) 090646 8000 E-MAIL: j.jeonard@ait.ie			

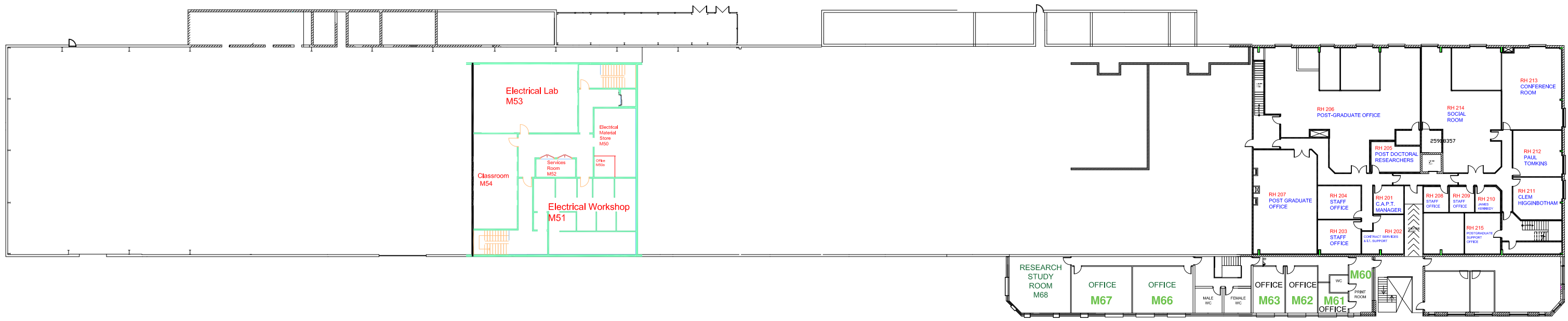



2. Work to figured dimensions only. Do not scale drawing.
3. The contractor is responsible for checking all levels and dimension on site and shall refer all discrepancies to the Architect.
4. Where appropriate, for further details contact Estates Department.
5. Proprietary items shall be fixed in strict accordance with manufacturers instructions.
6. Sizes of proprietary items shall be checked with manufacturer.
7. The contractor shall be responsible for the coordination of structure, finishes and services.

ISSUE STATUS	No.	Date	Revision	Initials
TENDER				
CONSTRUCTION				
AS BUILT				

Project: TUS MIDLANDS MCCARRICK BUILDING - EAST CAMPUS - INFORMATION LAYOUT
 Drawing Title: MCCARRICK BUILDING LAYOUT
 Drawing No: MC-EC-2201
 Rev: REV
 Drawn: J.J.L.
 Date: NOV 2022
 Scale: NTS
 Technological University of the Shannon - Midlands Midwest, Athlone, Co. Westmeath, Ireland
 TEL: (353) 090646 8000
 E-MAIL: j.j.leonard@tus.ie

