

**AiT**

ATHLONE INSTITUTE OF TECHNOLOGY  
 ESTATES OFFICE  
 DUBLIN RD.  
 ATHLONE  
 CO. WESTMEATH  
 PHONE: +353 (0)90 648 3036

TITLE:	ATHLONE INSTITUTE OF TECHNOLOGY MAIN INSTITUTE BUILDING
JOB NO.:	
DRAWING:	GROUND FLOOR PLAN
SCALE:	NTS
DATE:	20/09/16
REV.:	A
DRAWN BY:	CC



**AiT**  
 ATHLONE INSTITUTE OF TECHNOLOGY  
 ESTATES OFFICE  
 DUBLIN RD.  
 ATHLONE  
 CO. WESTMEATH  
 PHONE: +353 (0)90 648 3036

TITLE:	ATHLONE INSTITUTE OF TECHNOLOGY MAIN INSTITUTE BUILDING
JOB NO:	
DRAWING:	FIRST FLOOR PLAN
SCALE:	NTS
DATE:	20/09/16
REV:	A
DRAWN BY:	CC



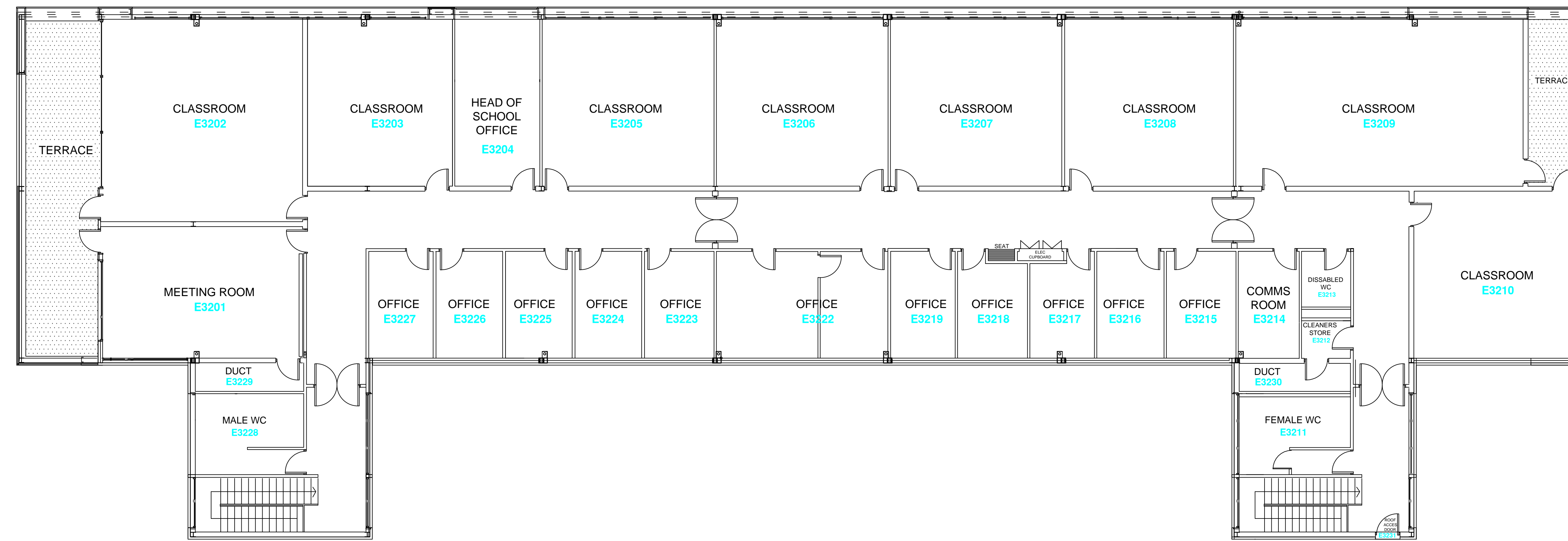

ATHLONE INSTITUTE OF TECHNOLOGY  
 ESTATES OFFICE  
 DUBLIN RD.  
 ATHLONE  
 CO. WESTMEATH  
 PHONE: +353 (0)90 648 3036

TITLE:	ATHLONE INSTITUTE OF TECHNOLOGY MAIN INSTITUTE BUILDING
JOB NO.:	
DRAWING:	SECOND FLOOR PLAN
SCALE:	NTS
DATE:	20/09/16
REV:	A
DRAWN BY:	CC