

TUS - ATHLONE CAMPUS ESTATES
 OFFICE
 UNIVERSITY RD
 ATHLONE
 CO. WESTMEATH
 PHONE: +353 (0)90 648 3036

TITLE:	NURSING & HEALTH SCIENCES BUILDING
JOB NO:	-
DRAWING:	FIRST FLOOR PLAN
SCALE:	NTS
DATE:	06/06/14
REV:	A
DRAWN BY:	CC

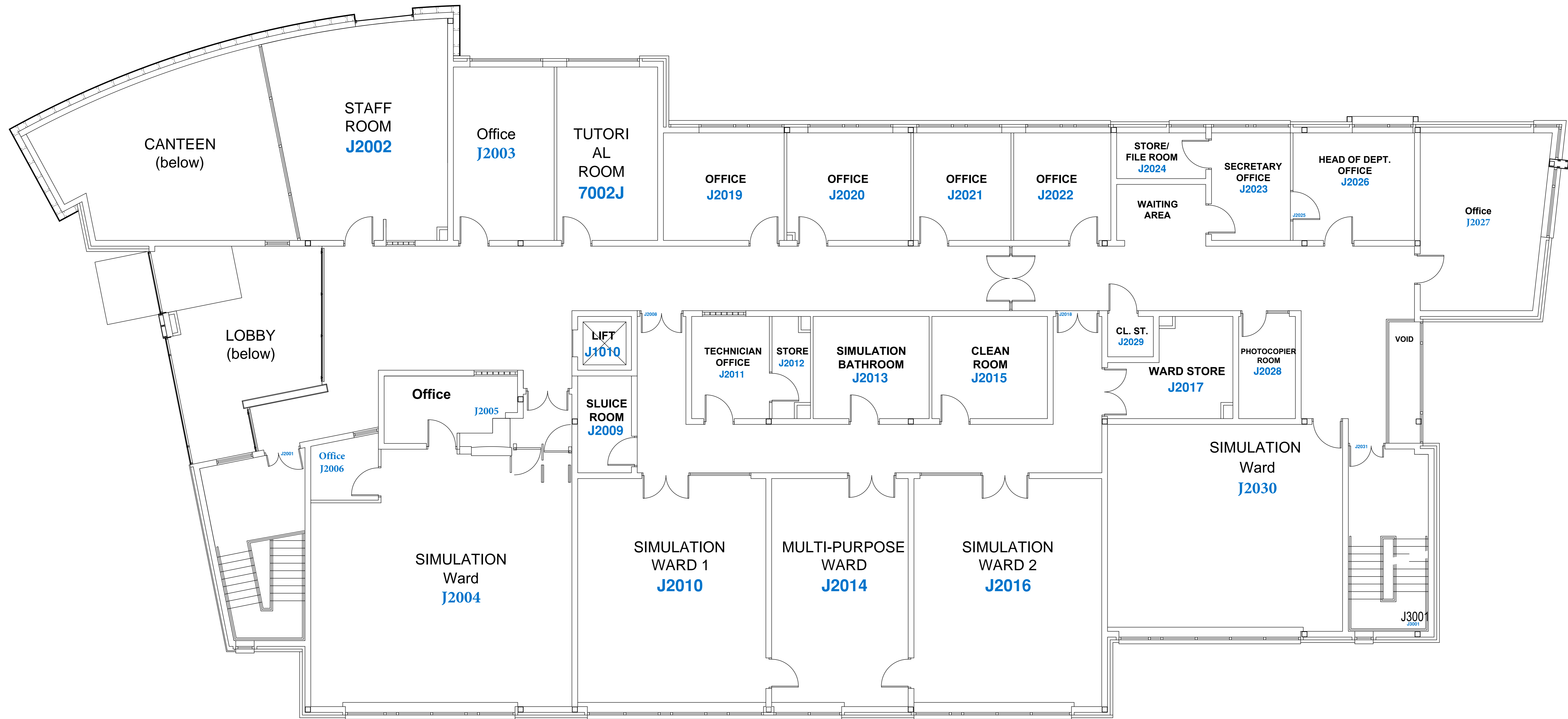

TUS ATHLONE, ESTATES OFFICE
 UNIVERSITY RD
 ATHLONE
 CO. WESTMEATH
 PHONE: +353 (0)90 648 3036

TITLE:	NURSING & HEALTH SCIENCES BUILDING
JOB NO:	-
DRAWING:	FIRST FLOOR PLAN
SCALE:	NTS
DATE:	06/06/14
REV:	A
DRAWN BY:	CC